

THREAD PIN GAUGE RA



New product!
Suitable when screw holes on workpiece is not chamfered



- Threaded portion has 1/15 taper starting at half way point to secure gauge to workpiece.
- Gauge will hold secure to workpiece for holes that are not chamfered to allow measurement of hole angle, etc. which can not be measured with traditional pin gauges.
- Also suitable for deburring Process

SPECIFICATIONS

Accuracy	Runout between measurement part and thread part : Model No. RAOO-1...within 0,01mm
	Runout between measurement part and thread part : Model No. RAOO-2...within 0,015mm
	Runout between measurement part and thread part : Model No. RAOO-3...within 0,02mm
	Accuracy of ϕa : within $\pm 0,005$ mm
MATERIAL	Stainless Steel (SUS303)

[DIMENSIONS]

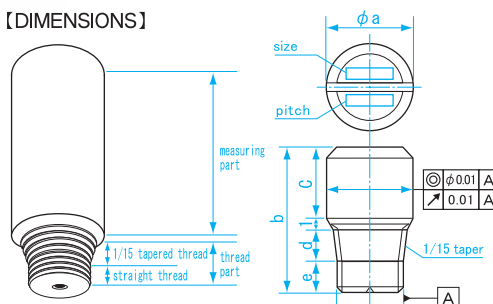

Size List

Model No.	Size	a (mm)	b (mm)	c (mm)	d (mm)	e (mm)	
RA125-1	M1 × P0,25	2	8,0	4,5	1,50	1,00	
RA125-2	M1 × P0,25		13,5	10,0			
RA125-3	M1 × P0,25		23,5	20,0			
RA204-1	M2 × P0,4	3	10,0	4,5	2,50	2,00	
RA204-2	M2 × P0,4		25,5	20,0			
RA204-3	M2 × P0,4		35,5	30,0			
RA305-1	M3 × P0,5	4	12,0	5,0	3,50	2,50	
RA305-2	M3 × P0,5		27,0	20,0			
RA305-3	M3 × P0,5		37,0	30,0			
RA407-1	M4 × P0,7	5	14,0	6,0		3,50	3,50
RA407-2	M4 × P0,7		28,0	20,0			
RA407-3	M4 × P0,7		38,0	30,0			
RA508-1	M5 × P0,8	6	16,0	7,0	4,00	4,00	
RA508-2	M5 × P0,8		29,0	20,0			
RA508-3	M5 × P0,8		39,0	30,0			
RA610-1	M6 × P1,0	7	18,0	8,0		4,00	5,00
RA610-2	M6 × P1,0		30,0	20,0			
RA610-3	M6 × P1,0		40,0	30,0			
RA8125-1	M8 × P1,25	9	19,0	8,5	4,50		5,00
RA8125-2	M8 × P1,25		30,5	20,0			
RA8125-3	M8 × P1,25		40,5	30,0			
RA1015-1	M10 × P1,5	11	21,0	8,5	5,50	6,00	
RA1015-2	M10 × P1,5		32,5	20,0			
RA1015-3	M10 × P1,5		42,5	30,0			
RA1215-1	M12 × P1,5	13	23,0	8,5	6,50	7,00	
RA1215-2	M12 × P1,5		34,5	20,0			
RA1215-3	M12 × P1,5		44,5	30,0			
RA12175-1	M12 × P1,75		23,0	8,5			
RA12175-2	M12 × P1,75		34,5	20,0			
RA12175-3	M12 × P1,75		44,5	30,0			
RA1415-1	M14 × P1,5	15	23,5	8,5	6,50	7,50	
RA1415-2	M14 × P1,5		35,0	20,0			
RA1415-3	M14 × P1,5		45,0	30,0			
RA1615-1	M16 × P1,5	17	23,5	8,5		7,00	8,00
RA1615-2	M16 × P1,5		35,0	20,0			
RA1615-3	M16 × P1,5		45,0	30,0			
RA1815-1	M18 × P1,5	19	24,5	8,5	7,00	8,00	
RA1815-2	M18 × P1,5		36,0	20,0			
RA1815-3	M18 × P1,5		46,0	30,0			